



Van Beest P-6036 Heavy Duty Load Monitoring Shackle



Euroload Limited supply a range of telemetry load monitoring shackles, utilizing the excellent quality of the Van Beest P-6036 safety bow. We can supply a new fully stainless-steel load pin or use the existing steel pin to create a load monitoring pin. The pin is down hole strain gauged and sealed both ends to produce an ingress protection rating of IP68.

We counterbore our heavy duty fully stainless-steel electronic housing into the load pin to produce ultimate strength. Fitted with our unique removeable battery cover which requires no tools on site and an IP68 watertight rating. Up to 6 months constant transmit on fast update on 2 off AA batteries. Can last up to 2 years using our optional DD battery configuration.

We supply a protective load bobbin to protect the load pin and centralize the load for ultimate accuracy. Accuracy +/- 1% of applied load. Excellent repeatability. Custom bobbins available on request.

The output as standard is ELT24 c/w our ELT24-HS2 receiver handset. The options to receive the signal are extensive from, large digit displays, USB receivers for datalogging, free software, relay modules, digital gateways and more. See our ELT Made To Measure Brochure for full options.

This product is designed for the harshest of environment's developed from over 30 years experience working in the Oil and Gas sector.

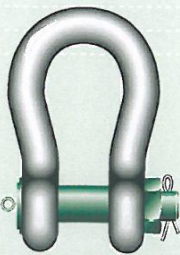

P-6036

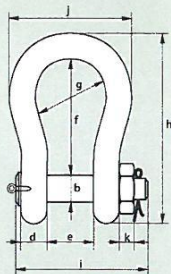

Green Pin® Heavy Duty Shackles

bow shackles with safety bolt

- Material** : bow and pin alloy steel, Grade 8 quenched and tempered
- Safety Factor** : MBL equals 5 x WLL
- Finish** : shackle bow painted silver, pin painted green (120 tons shackle is hot dipped galvanized)
- Certification** : at no extra charges this product can be supplied with a works certificate, 3.1 material certificate, manufacturer test certificate, EC Declaration of Conformity and all shackles starting from 150 tons are supplied with a Lloyd's Register of Shipping Certificate on proof load
- Note** : for details on dimensions and tolerances please consult our CAD drawings, these are available on request.

working load limit	diameter bow	diameter pin	diameter eye	width eye	width inside	length inside	width bow	length	length bolt	width	thickness nut	weight each
t	a	b	c	d	e	f	g	h	i	j	k	kg
mm	mm	mm	mm	mm	mm	mm	mm	mm	mm	mm	mm	
120	95	95	208	91	147	400	238	647	440	428	50	110
150	105	108	238	102	169	410	275	688	490	485	60	160
200	120	130	279	113	179	513	290	838	520	530	60	235
250	130	140	299	118	205	554	305	904	560	565	65	285
300	140	150	325	123	205	618	305	996	575	585	70	340
400	170	175	376	164	231	668	325	1114	690	665	70	560
500	180	185	398	164	256	718	350	1190	720	710	70	685
600	200	205	444	189	282	718	375	1243	810	775	70	880
700	210	215	454	204	308	718	400	1263	870	820	70	980
800	210	220	464	204	308	718	400	1270	870	820	70	1100
900	220	230	485	215	328	718	420	1296	920	860	70	1280
1000	240	240	515	215	349	718	420	1336	940	900	70	1460
1250	260	270	585	230	369	768	450	1456	1025	970	70	1990
1500	280	290	625	230	369	818	450	1556	1025	1010	70	2400

In inch

working load limit	diameter bow	diameter pin	diameter eye	width eye	width inside	length inside	width bow	length	length bolt	width	thickness nut	weight each
t	a	b	c	d	e	f	g	h	i	j	k	lbs
inch	inch	inch	inch	inch	inch	inch	inch	inch	inch	inch	inch	
120	3 3/4	3 3/4	8 3/16	3 19/32	5 25/32	15 3/4	9 3/8	25 15/32	17 5/16	16 27/32	1 31/32	243
150	4 1/8	4 1/4	9 3/8	4 1/32	6 21/32	16 5/32	10 13/16	27 3/32	19 9/32	19 3/32	2 3/8	353
200	4 23/32	5 1/8	10 31/32	4 7/16	7 1/16	20 3/16	11 13/32	33	20 15/32	20 7/8	2 3/8	518
250	5 1/8	5 1/2	11 25/32	4 21/32	8 1/16	21 13/16	12	35 19/32	22 1/16	22 1/4	2 9/16	628
300	5 1/2	5 29/32	12 25/32	4 27/32	8 1/16	24 11/32	12	39 7/32	22 5/8	23 1/32	2 3/4	750
400	6 11/16	6 7/8	14 13/16	6 15/32	9 3/32	26 5/16	12 25/32	43 27/32	27 5/32	26 3/16	2 3/4	1235
500	7 3/32	7 9/32	15 21/32	6 15/32	10 3/32	28 9/32	13 25/32	46 27/32	28 11/32	27 15/16	2 3/4	1510
600	7 7/8	8 1/16	17 15/32	7 7/16	11 3/32	28 9/32	14 3/4	48 15/16	31 7/8	30 1/2	2 3/4	1940
700	8 9/32	8 15/32	17 7/8	8 1/32	12 1/8	28 9/32	15 3/4	49 23/32	34 1/4	32 9/32	2 3/4	2161
800	8 9/32	8 21/32	18 9/32	8 1/32	12 1/8	28 9/32	15 3/4	50	34 1/4	32 9/32	2 3/4	2425
900	8 21/32	9 1/16	19 3/32	8 15/32	12 29/32	28 9/32	16 17/32	51 1/32	36 7/32	33 27/32	2 3/4	2822
1000	9 7/16	9 7/16	20 9/32	8 15/32	13 3/4	28 9/32	16 17/32	52 19/32	37	35 7/16	2 3/4	3219
1250	10 1/4	10 5/8	23 1/32	9 1/16	14 17/32	30 1/4	17 23/32	57 5/16	40 11/32	38 3/16	2 3/4	4387
1500	11 1/32	11 13/32	24 19/32	9 1/16	14 17/32	32 7/32	17 23/32	61 1/4	40 11/32	39 3/4	2 3/4	5291